

**STRAIGHT PCB RECEPTACLE**

**R197.150.A07**

Series : **SMB**  
**CARLOCK**

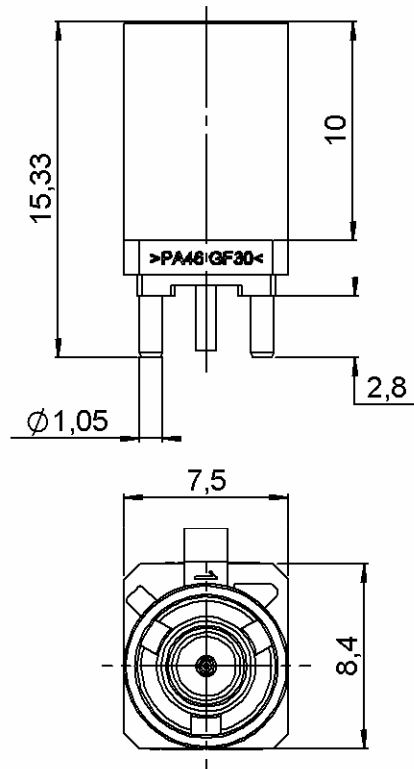

**PANEL CUT OUT**

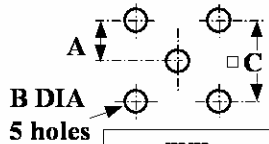

	mm	
	Maxi	mini
<b>A</b>	2.59	2.49
<b>B</b>	1.4	1.3
<b>C</b>	5.16	5

**CODING A**

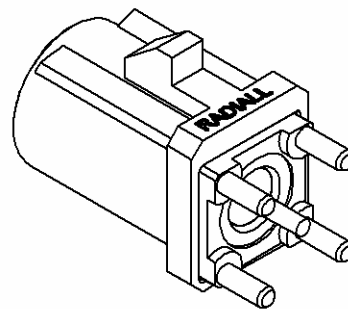
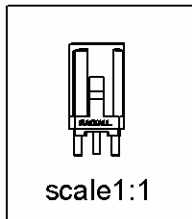

All dimensions are in mm.

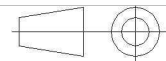

COMPONENTS	MATERIALS	PLATING (µm)
<b>BODY</b>	<b>BRASS</b>	<b>TIN 3 OVER NICKEL 2</b>
<b>CENTER CONTACT</b>	<b>BRASS</b>	<b>GOLD 0.5 OVER NICKEL 2</b>
<b>OUTER CONTACT</b>	-	-
<b>INSULATOR</b>	<b>PTFE</b>	-
<b>GASKET</b>	-	-
<b>OTHERS PARTS</b>	<b>PA 46 GF30 (STANYL TS200F6) Color</b>	-
-	<b>BLACK(RAL9005)</b>	-
-	-	-
-	-	-

Issue : 0648 A

In the effort to improve our products, we reserve the right to make changes judged to be necessary.



**STRAIGHT PCB RECEPTACLE**

**R197.150.A07**

Series : **SMB**  
**CARLOCK**

**PACKAGING**

**SPECIFICATION**

**QS9000 A 00**

Standard	Unit	Other
<b>100</b>	<b>'W' option</b>	<b>Contact us</b>

**ELECTRICAL CHARACTERISTICS**

**ENVIRONMENTAL**

Impedance	<b>50</b>	$\Omega$
Frequency	<b>0-4</b>	GHz
VSWR	<b>1.05*</b> + <b>0,0080</b>	x F(GHz) Maxi
Insertion loss	<b>0.03*</b>	$\sqrt{F}$ (GHz) dB Maxi
RF leakage	- ( <b>57</b> )	- F(GHz)) dB Maxi
Voltage rating	<b>500</b>	Veff Maxi
Dielectric withstanding voltage	<b>1000</b>	Veff mini
Insulation resistance	<b>1000</b>	M $\Omega$ mini

Operating temperature	<b>-40/+110</b>	$^{\circ}$ C
Hermetic seal	<b>NA</b>	Atm.cm3/s
Panel leakage	<b>NA</b>	

**OTHER CHARACTERISTICS**

Assembly instruction

Others :

\* COAX TRANSMISSION LINE ONLY

**MECHANICAL CHARACTERISTICS**

Center contact retention		
Axial force (before soldering)	<b>5</b>	N mini
Axial force (after soldering)	<b>10</b>	N mini
Torque	<b>NA</b>	N.cm mini
Recommended torque		
Mating	<b>NA</b>	N.cm
Panel nut	<b>NA</b>	N.cm
Mating life	<b>100</b>	Cycles mini
Weight	<b>1,2700</b>	g

Issue : 0648 A

In the effort to improve our products, we reserve the right to make changes judged to be necessary.

